

► Features

- Stores up to 9 units of 19" equipment
- Loading capacity of 50 Kg
- Integrated ventilation grid on top
- Cable entry on top & bottom (closable)
- Removable sides for easy installing & cabling
- Tempered glass door with keylock
- Front in depth adjustable 19" profiles (max 370 mm)
- Punched square holes for use with snap-in cage nuts



► Description

The EPR409 is an economical wall mountable 19" rack compliant to ANSI/EIA RS-310D, DIN41491, IEC 60297 standards. The construction is made of an 1.5 mm thick steel frame with 1.0 mm thick plates and is finished with a black (RAL9004) fine structured powder coating. It stores up to 9 units of 19" equipment, comes fully assembled and can easily be mounted on the wall. The 19" mounting profile with punched square holes for use with snap-in cage nuts in combination with the printed unit measurement indicators ensure easy fitting of the equipment. The tempered glass front door is reversible and secured with a key lock which keeps the equipment accessible for authorized persons only. Other present features are removable sides and in depth adjustable 19" profiles allowing easy and flexible cabling & installation.

► Technical Drawing

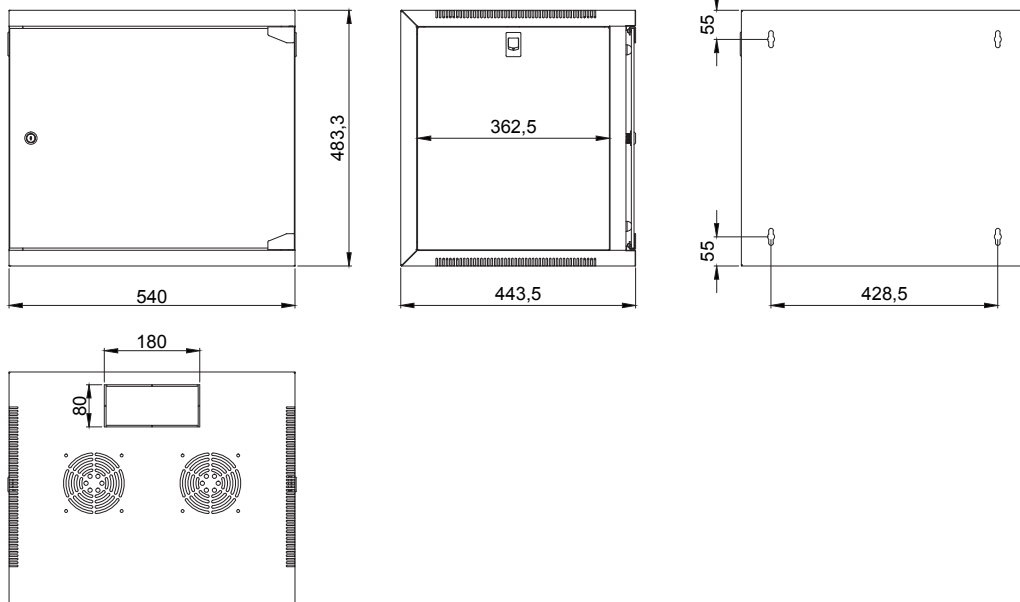

► Specifications

PROPERTY	VALUE
Unit height	9 HE
Max usable depth	370 mm
Max load	50 kg
Width	540 mm
Depth	443,5 mm
Height	483,3 mm
Weight	xxx kg
Rack color	Black (RAL 9004)

► Included Accessories

ARTICLE	QUANTITY
Key for front door	2
Cage nuts + screws	25

► Optional Accessories

ARTICLE	DESCRIPTION
KM600	Cage nuts
KS600	Screws for cage nuts