

B-Station

The B-Station is a wall-mount button panel with 6 push-buttons. It can remote control any function within the CueCore or CueluxPro. The buttons are back-lit and can provide visual feedback, for example, to indicate the selected cue or active show.

Multiple B-Stations can be networked together. The button station supports various open protocols like OSC, UDP and Art-Net. This allows it to be integrated with other 3rd party network-based systems as well, e.g. audio, video or show control systems.

For small architectural projects, the B-Station contains an inbuilt lighting controller that is capable of programming 32 fixtures and a maximum of 768 cues. All programming is done via the web-interface, no additional client software is required.

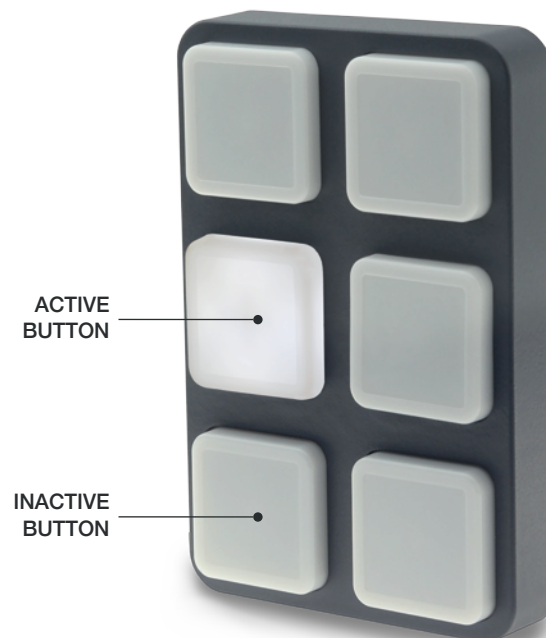

SPECIFICATIONS

- Ethernet port
- Programming via web-interface
- 6x back-lit push-button
- DMX512-A (ANSI E1.11) port (Opto-isolated)
- Art-Net
- OSC & UDP
- Power over Ethernet (class I)
- Wall-mount
- Operating temperature -20°C to +50°C (-4°F to 122°F)
- Compliance EN55103-1 EN55103-2
- Shipped with adhesive labels (numbers, icons, colours)
- Bundled with vManager and Kiosc software